



VF3

Push Back Probe 118 mil

Centers (mm/mil)	3,00 / 118
Current	8,0 A
Current (Switch Receptacle)	1,0 A
R typ	30 mOhm
Temperature	-45°C...+100°C

Spring Force (cN ±20%)

Version	Preload	Nominal
Standard	100	500
Standard	200	1000
Standard	300	1500

Travel (mm)

Version	Nominal	Maximum
Standard	5,0	5,5
Thread (M)	2,0x0,2	
Wrench Size	2,2	
Pointing Accuracy	±0,10 mm	

Materials and Plating

Plunger	see Tip Style
Barrel	Brass, gold plated
Spring	Music wire, gold plated
Receptacles	Brass, gold plated

Accessories

Alignment tool receptacle	FAWZVF3
Screw-in tool probe max. Tip-Ø 2,3 mm	FWZVF3S4; FWZVF3T4
Screw-in tool probe max. Tip-Ø 2,7 mm	FWZVF3; FWZVF3T
Screw-in tool probe max. Tip-Ø 4,0 mm	FWZVF3S3; FWZVF3T3

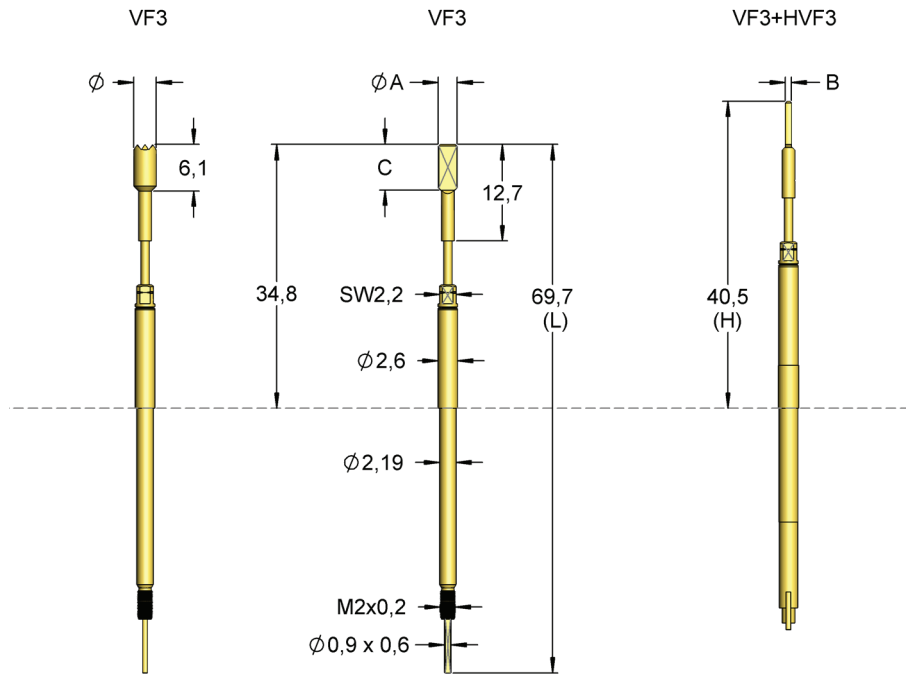

For the permissible leakage rate see information in the technical introduction.
The receptacle HVF3SHATS1 is available with a switching travel of 4.5 mm.

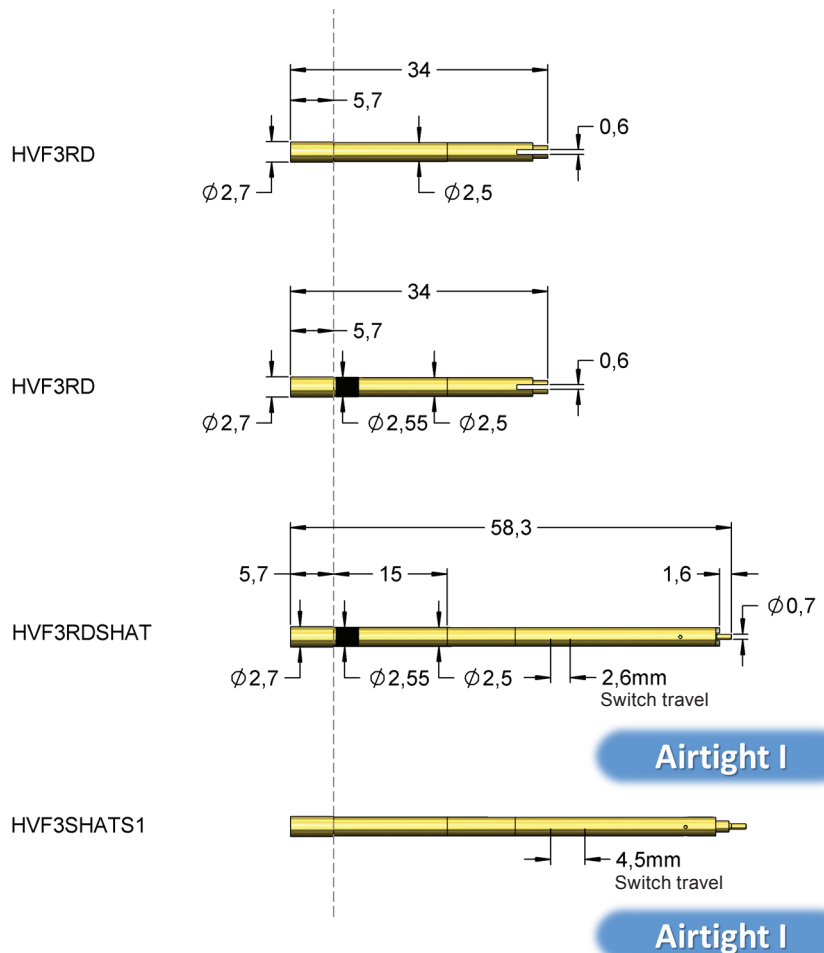



VF3

Push Back Probe 118 mil

Centers (mm/mil)	3,00 / 118
Current	8,0 A
Current (Switch Receptacle)	1,0 A
R typ	30 mOhm
Temperature	-45°C...+100°C

Series	Tip-Ø	Spring Force (N)
VF3	05	15
Tip Style	Material	Plating
G	B	190

Material: B = BeCu
Tip-Ø: 190 = 1,90 mm (e.g.)
Plating: G = Gold plated
Version: L = Long version
Receptacle: Order code according drawing

Tip Style	Number	Material	Ø in mm	Plating	Version
	05	B	1,90	G	-
	05	B	2,20	G	-
	05	B	3,00	G	-
	06	B	2,70	G	-
	06	B	3,00	G	-
	12	B	2,30	G	-
	17	B	1,50	G	-
	17	B	1,80	G	-
	17	B	2,30	G	-
	17	B	3,00	G	-

KF80

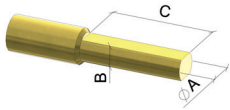

KF83

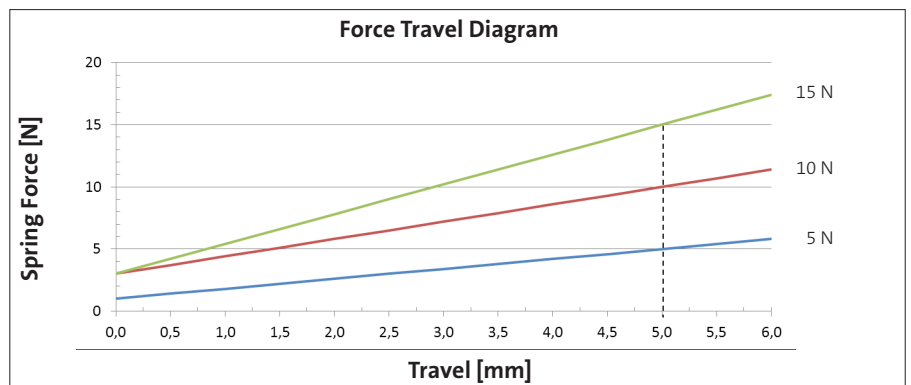
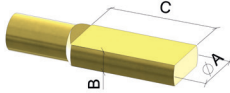

Order Code	Number	Ø A	B	C	H	L	Version	Screw-in tool
VF380B0002G10	80	1,40	0,50	6,00	40,50	69,70	-	FWZVF3; FWZVF3T
VF380B0002G15	80	1,40	0,50	6,00	40,50	69,70	-	FWZVF3; FWZVF3T
VF380B0001G10	80	1,60	0,50	6,00	40,50	69,70	-	FWZVF3; FWZVF3T
VF380B0001G15	80	1,60	0,50	6,00	40,50	69,70	-	FWZVF3; FWZVF3T
VF383B0004G10	83	1,90	0,50	6,00	40,50	69,70	-	FWZVF3; FWZVF3T
VF383B0004G15	83	1,90	0,50	6,00	40,50	69,70	-	FWZVF3; FWZVF3T
VF383B0005G10	83	1,90	0,80	6,00	40,50	69,70	-	FWZVF3; FWZVF3T
VF383B0005G15	83	1,90	0,80	6,00	40,50	69,70	-	FWZVF3; FWZVF3T
VF383B0007G15	83	2,20	1,20	6,00	40,50	69,70	-	FWZVF3; FWZVF3T
VF383B0002G15	83	2,50	0,50	6,00	40,50	69,70	-	FWZVF3; FWZVF3T
VF383B0001G10	83	2,50	0,80	6,00	40,50	69,70	-	FWZVF3; FWZVF3T
VF383B0001G15	83	2,50	0,80	6,00	40,50	69,70	-	FWZVF3; FWZVF3T
VF383B0003G15	83	2,50	1,50	6,00	40,50	69,70	-	FWZVF3; FWZVF3T
VF383B0008G10	83	2,70	0,80	6,00	40,50	69,70	-	FWZVF3; FWZVF3T
VF383B0008G15	83	2,70	0,80	6,00	40,50	69,70	-	FWZVF3; FWZVF3T
VF383B0004G15L	83	1,90	0,50	12,00	46,50	75,70	L	FWZVF3; FWZVF3T
VF383B0009G15L	83	2,10	0,70	12,00	46,50	75,70	L	FWZVF3; FWZVF3T
VF383B0010G15	83	2,70	0,80	10,00	44,50	73,70	S1	FWZVF3; FWZVF3T
VF383B0006G15	83	4,00	0,60	10,00	44,50	73,70	S1	FWZVF3S3; FWZVF3T3