

# HKR 612 M

High Current Clamps up to 100 A  
for Round Post- $\varnothing$  3,0/4,0/6,0 mm

**NEW**

**Grid:**

$\geq 10,0$  mm

$\geq 400$  Mil

Installation height with KS: 29,5 mm (.1161)

Recommended stroke: 4,4 mm (.173)

## Mounting and functional dimensions

HKR-612 300 100 S 10003 M  
(for 3 mm tip diameter)

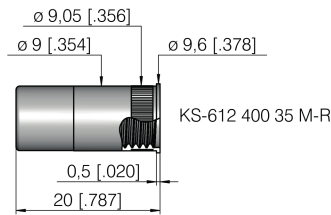
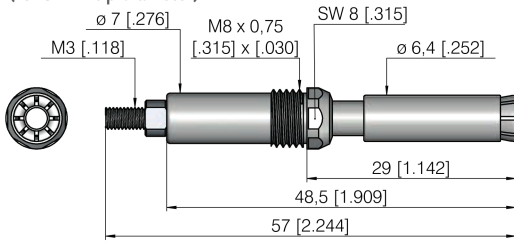

HKR-612 400 100 S 10003 M  
(for 4 mm tip diameter)

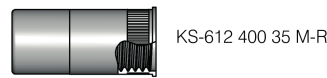
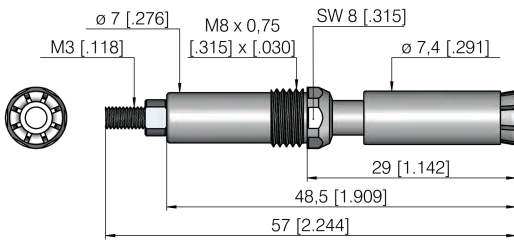

HKR-612 600 130 S 20003 M  
(for 6 mm tip diameter)

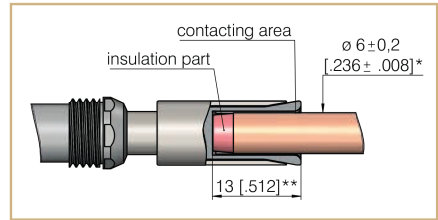
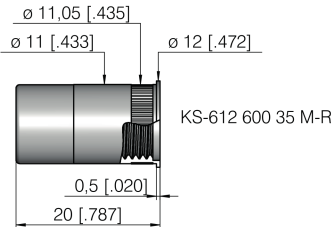
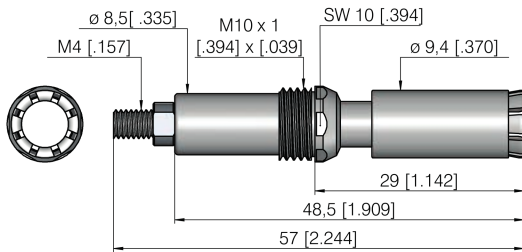

Example of contacting with HKR-612 600 ... M,  $\varnothing$  6 mm

### Note:

The high current clamps **HKR-612 M** enable the reliable contacting of round posts and threads up to 100 A. When contacting, the contact lamellas are pressed on the bolt without scratching it.

The high current clamps are especially recommended for round contacts with contact protection, which cannot be contacted from the top.

The **HKR-612 M** is also ideal for harsh testing conditions with vibrations, contamination and longer testing cycles because of its robust design.

### Note:

High current clamps for further round post- $\varnothing$  and immersion depth (round post lengths) upon request.

### Materials

Plunger:	BeCu, silver-plated
Barrel:	Brass, silver-plated
Spring:	Stainless steel
Receptacle:	Brass, silver-plated

### Operating temperature

Standard:  $-100^{\circ}$  up to  $+200^{\circ}$  C

### Mounting hole size

for KS-612 400 35 M-R  
in CEM1 and FR4:

$\varnothing$  9,00 - 9,02 mm  
(.3543 - .3551)

for KS-612 600 35 M-R  
in CEM1 and FR4:

$\varnothing$  11,00 - 11,02 mm  
(.4331 - .4339)

### Recommended tightening torque

HKR-612 M in KS-612 400 35 M-R:	50 cNm
Cable at HKR-612 300/400 ... M:	1 Nm
HKR-612 M in KS-612 600 35 M-R:	60 cNm
Cable at HKR-612 600 ... M:	2 Nm

### Electrical data

#### Current rating (at room temp.)

HKR-612 300 ... M:	max. 35 A
HKR-612 400 ... M:	max. 50 A
HKR-612 600 ... M:	max. 100 A

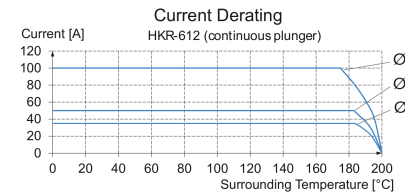
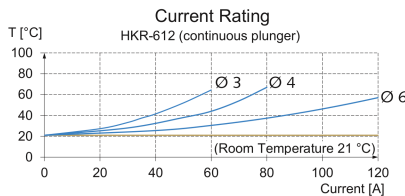

### Round post to be contacted

#### for HKR-612 300/400 ... M

Min. immersion depth bolt**:	10 mm (.394)
Round post- $\varnothing$ *:	3,0 mm $\pm$ 0,2 mm (.118 $\pm$ .008)
	4,0 mm $\pm$ 0,2 mm (.157 $\pm$ .008)

#### for HKR-612 600 ... M

Min. immersion depth bolt**:	13 mm (.512)
Round post- $\varnothing$ *:	6,0 mm $\pm$ 0,2 mm (.236 $\pm$ .008)

### Mechanical data

#### Immersion depth

HKR-612 300/400 ... M: **	10 mm (.394)
HKR-612 600 ... M: **	13 mm (.512)
Working stroke:	4,4 mm (.173)
Max. working stroke:	5,5 mm (.217)
Spring force at working stroke	
HKR-612 300/400 ... M:	10 N (36oz)
HKR-612 600 ... M:	20 N (72oz)

## Ordering example

Series	Round post- $\varnothing$ (1/100 mm)	Immersion depth (1/10 mm)	Plating S = Silver	Spring force (dN)	Collar height (mm)	Type
--------	---	------------------------------	-----------------------	----------------------	-----------------------	------

High current clamp ( $\varnothing$  3 mm):

H K R 6 1 2 3 0 0 1 0 0 S 1 0 0 0 3 M

High current clamp ( $\varnothing$  4 mm):

H K R 6 1 2 4 0 0 1 0 0 S 1 0 0 0 3 M

High current clamp ( $\varnothing$  6 mm):

H K R 6 1 2 6 0 0 1 3 0 S 1 0 0 0 3 M

Receptacle for HKR-612 300/400 ... M:

K S - 6 1 2 4 0 0 3 5 - M - R

Receptacle for HKR-612 600 ... M:

K S - 6 1 2 6 0 0 3 5 - M - R