



F822

Kelvin Probe 217 mil Plug-in

Centers (mm/mil)	5,50 /217
Continuous current (Circular)	6,0 A
Continuous current (Internal)	1,6 A
Frequency	1,2 GHz
Temperature	-20°C...+80°C

Spring Force (cN ±20%)

	Preload	Nominal
Total	-	650
Internal Cont.	100	200
Circular Cont.	250	450

Travel (mm)

	Nominal	Maximum
Internal Cont.	3,0	3,5
Circular Cont.	2,0	2,6

Materials and Plating

Internal Cont.	Steel, longtime gold plated
Circular Cont.	BeCu, gold plated
Barrel	Bronze, unplated
Spring Internal Cont.	Stainless steel, unplated
Spring Circular Cont.	Stainless steel, unplated
Receptacle	Brass, gold plated

Accessories

Insertion tool receptacle	FEWZ-822E0
---------------------------	------------

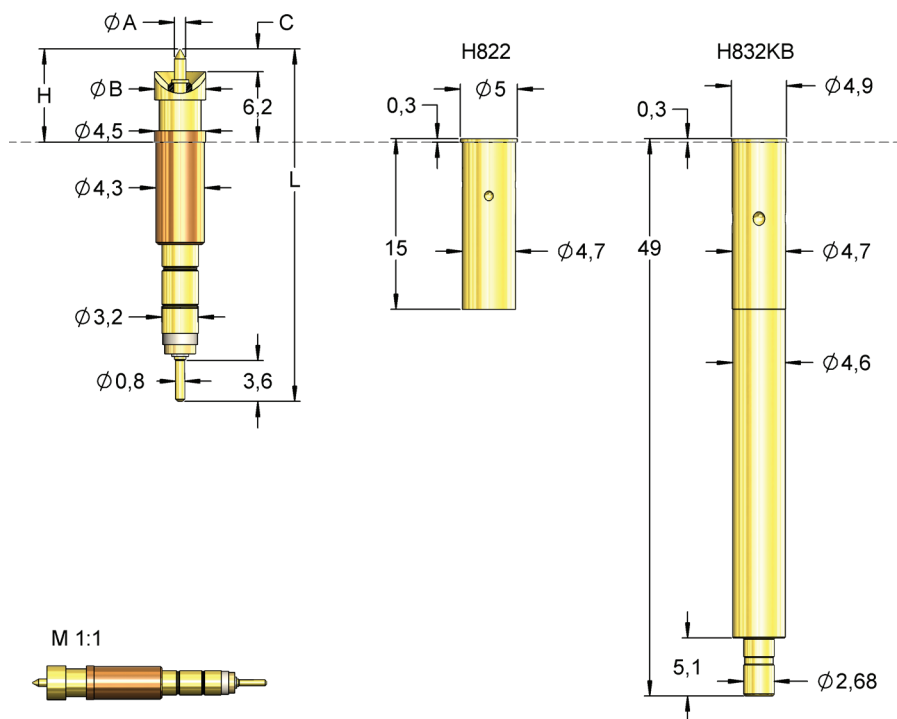

The special version **F82205S0007L650IK25** has a leading insulating cap at the inner contact for testing position and straightness of the Fakra connector pin.

In the **F82241S0008L650S1**, the Fakra connector ground (outer conductor) is contacted via the lamella-shaped contact cage, which ensures a secure contact.

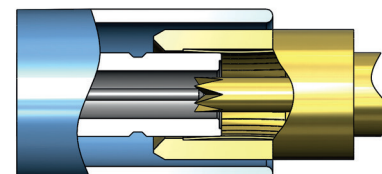
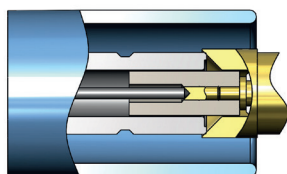

Order Code	Sense Pin	Tip Style	Ø A	Ø B	C	H	L	Version
F82201S0018L650		01	0,80	3,20	0,00	8,60	31,40	-
F82202S0016L650		02	1,50	4,00	1,00	7,20	30,00	-
F82203S0011L650		03	0,50	4,00	2,00	8,20	31,00	-
F82203S0001L650		03	1,00	4,00	2,00	8,20	31,00	-
F82203S0014L650		03	1,00	4,00	3,50	9,70	32,50	-
F82203S0003L650		03	1,00	4,50	2,00	8,20	31,00	-
F82203S0015L650		03	1,00	4,50	3,50	9,70	32,50	-
F82205S0007L650IK25		05	0,60	4,00	-2,50	10,50	33,30	IK25
F82205S0001L650		05	1,00	4,00	2,00	8,20	31,00	-
F82205S0003L650		05	1,00	4,50	2,00	8,20	31,00	-
F82205S0005L650		05	1,50	4,00	4,50	10,70	33,50	-
F82209S0016L650		09	1,50	4,00	1,00	7,20	30,00	-
F82211S0012L650		11	0,64	4,50	3,50	9,70	32,50	-
F82217S0006L650		17	0,64	4,00	2,00	8,20	31,00	-
F82217S0016L650		17	1,50	4,00	1,00	7,20	30,00	-
F82239S0001L650		39	1,00	4,00	2,00	8,20	31,00	-
F82241S0008L650S1		41	1,50	5,70	-1,80	12,50	35,30	S1



Accessories for Coaxial Probes F822 / F832

Mounting option 1

Order code: H822

Plug-in receptacle for soldering suitable for F822

Order code: H832

Threaded receptacle for soldering suitable for F832

Order code: H832RD

Threaded receptacle with knurl for soldering suitable for F832

Order code: H822AE

Connection element plug-in for soldering suitable for F822/F832

Mounting option 2

Order code: H832KB

Threaded coax combi receptacle with SSMB Mini connector suitable for F822/F832

Order code: H822AE1

Connection element with pre-assembled coaxial cable RG 174 and **straight** SSMB Mini connector
Impedance: 50 Ohm
Standard length: **600 mm**

Order code: H822AE2

Connection element with pre-assembled coaxial cable RG 174 and **angled** SSMB Mini connector
Impedance: 50 Ohm
Standard length: **600 mm**

Order code: H822AE3

Connection element with pre-assembled coaxial cable RG 174 and **straight** SSMB Mini connector
Impedance: 50 Ohm
Standard length: **2000 mm**

Additional option

Order code: H822IS

Plug-in insulating receptacle for insulated mounting into conductive material suitable for H822... for drill holes \varnothing 5,55 mm

Mounting option 1

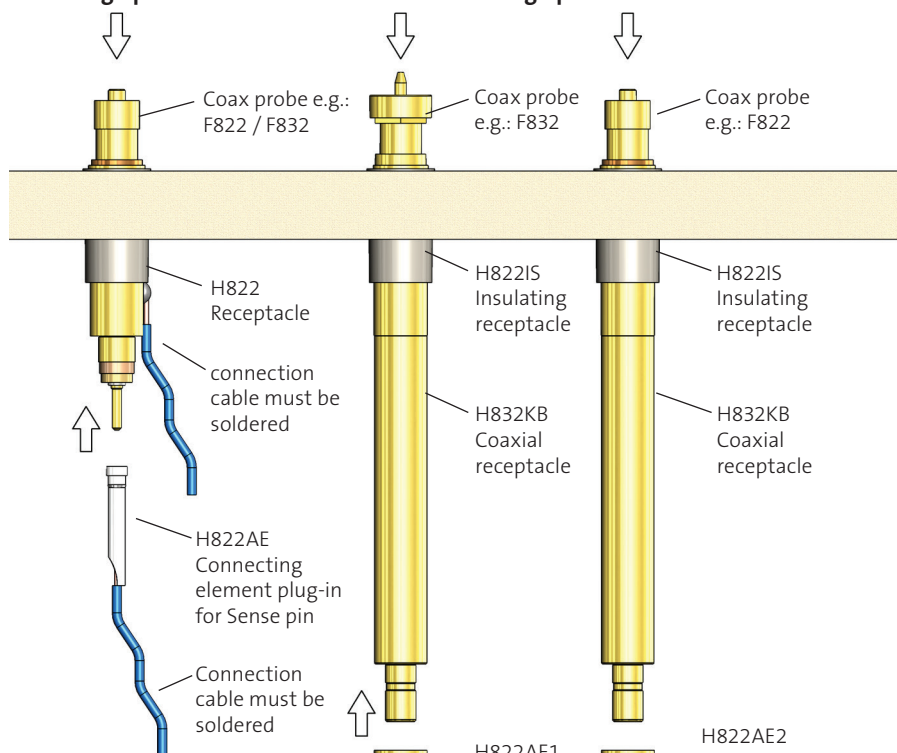

The pluggable F822 also can be used in all screwable receptacles of series H832.

