



# F819

**For electrical  
contacting of  
HSD female**

<b>Centers (mm/mil)</b>	12,0 / 472
<b>Current (Circular)</b>	10,0 A
<b>Current (Internal)</b>	3,0 A
<b>Temperature</b>	-45°C...+100°C

## Spring Force (cN ±20%)

	Preload	Nominal
Total	-	2020
Internal Cont.	75	130
Circular Cont.	900	1500

## Travel (mm)

	Nominal	Maximum
Internal Cont.	3,0	5,8
Circular Cont.	5,0	6,0
Wrench Size		6,0

## Materials and Plating

Internal Cont.	BeCu, gold plated
Circular Cont.	BeCu, gold plated
Barrel	Brass, gold plated
Spring Internal Cont.	Music Wire, silver plated
Spring Circular Cont.	Stainless steel, unplated

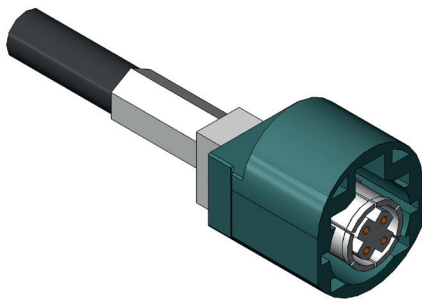

HSD-Female (H819AE1)

F81912B0001G2020

F81912B0001G2020

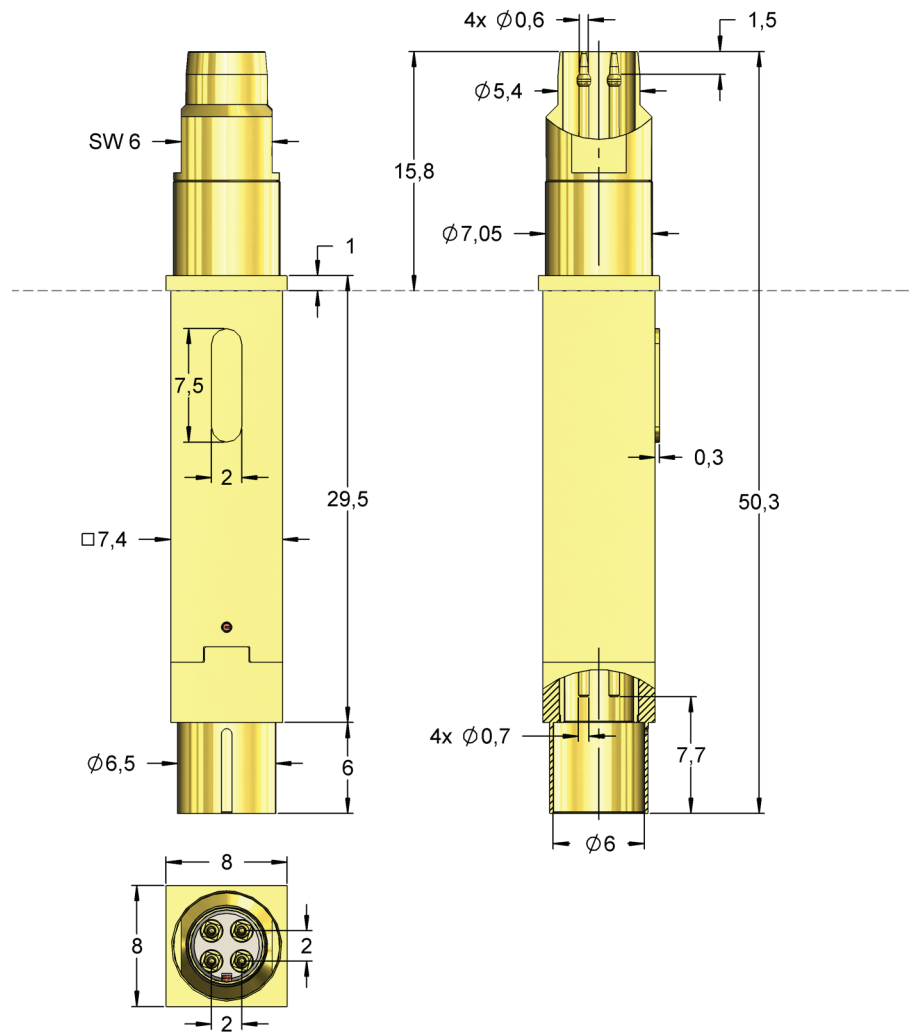

The F819 combines several advantages: Conical inlet of the external as well as internal contact for better contacting and compensation of tolerances. In addition, the screwed internal contacts (F17512B0023G150SPS1) prevent the contact from being pulled out of the receptacle. The probe is used for purely electrical contacting of HSD females.



By combining the connection elements H819AE2 and H819AE1 a **defined and reproducible measuring** setup with fix parameters can be realized.

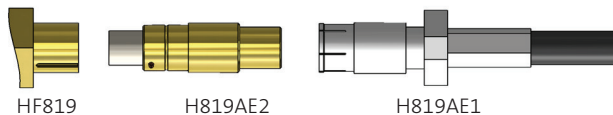

## Connection units selectable

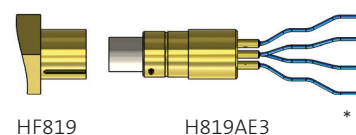

for direct soldering

\* deviating from standard, depending on diameter.

Order Code	Sense Pin	Tip Style	Ø A	Ø B	C	H	L	Version
F81912B0001G2020		12 *	max. 0,60	max. 5,40	- 1,50	15,80	50,30	-