

# HIGH CURRENT PROBES

## 1860C001

High Current Test Head  
up to 50 A for  
Contacting Uneven Surfaces

Centers (mm/mil)	12,0 / 472
Current	50,0 A
R typ	<4 mOhm
Temperature	-40°C...+200°C (H)

### Spring Force (cN ±20%)

Version	Preload	Nominal
C	300	480

### Travel (mm)

Version	Nominal	Maximum
C	1,0	1,2
Thread (M)		3,0
Wrench Size		10,0

### Materials and Plating

Plunger	BeCu, gold plated
Barrel	Copper, gold plated
Spring	Stainless steel, unplated

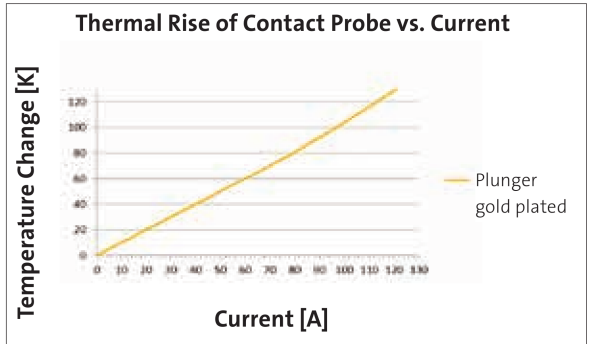
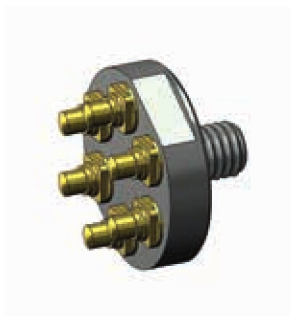
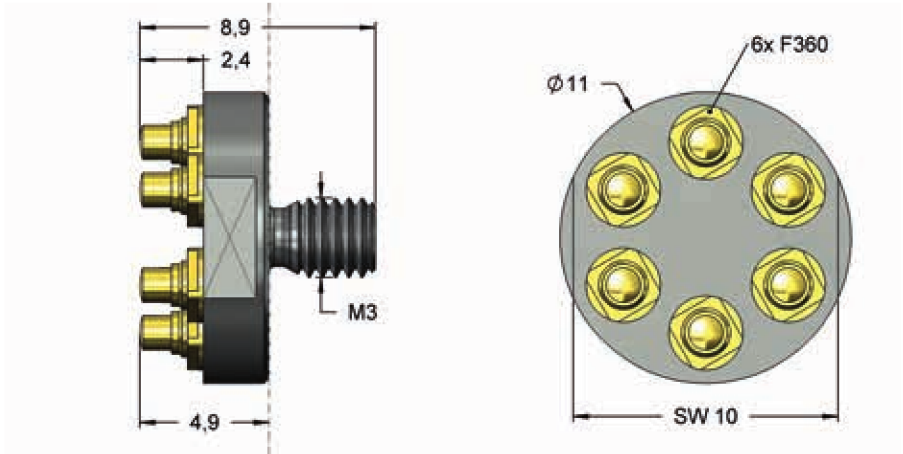

## 1860C006

High Current Test Head  
up to 50 A for  
Contacting Uneven Surfaces

Centers (mm/mil)	12,0 / 472
Current	100,0 A
R typ	<2 mOhm
Temperature	-40°C...+200°C (H)

### Spring Force (cN ±20%)

Version	Preload	Nominal
C	960	1920

### Travel (mm)

Version	Nominal	Maximum
C	0,9	1,2
Thread (M)		3,0
Wrench Size		10,0

### Materials and Plating

Plunger	Brass, gold plated
Barrel	Copper, gold plated
Spring	Stainless steel, unplated

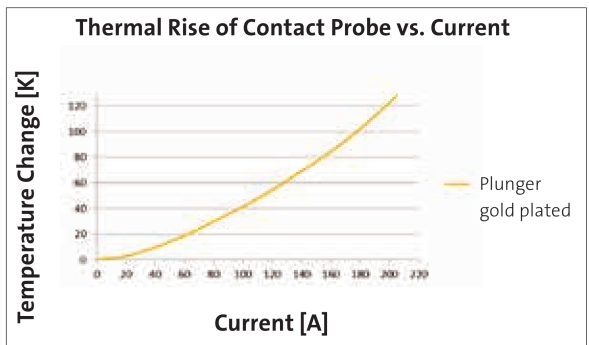
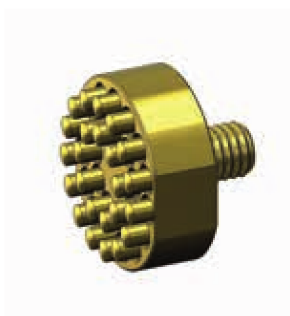
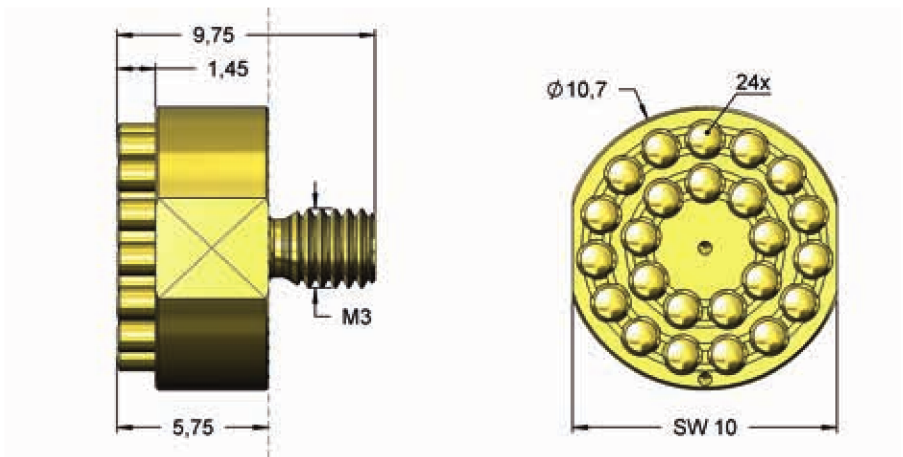

These contact blocks are screwed directly into conductive material. It is essential that not only the thread, but also the whole surface of the block has an electrical contact. The electrical connection can be realized also directly with the conductive material. The maximum current depends on the allowed temperature rise.